

D2 DriveStretcher For RoadRunner Compact+ LoadHauler Compact+

These instructions cover the basic gearbox assembly sequence.

For additional information, hints and tips you can refer to our Guidance Section (see brackets).

Note: If this is your first High Level Gearbox we recommend you read all notes thoroughly.

1. The main gearbox should be assembled up to the point when the Final Drive Carriage is fitted. This will be replaced by The DriveStretcher.

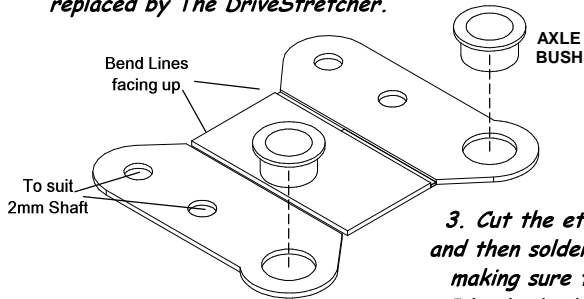

2. While the etches are still in the fret, progressively open out the holes to suit the components, so they're a push-fit (see A & B). Remove all burrs.

3. Cut the etches from the fret and then solder in the Axle Bushes, making sure they're fully home. File the bushes to size (see C).

4. Fold up the DriveStretcher with the bend lines on the inside (D).

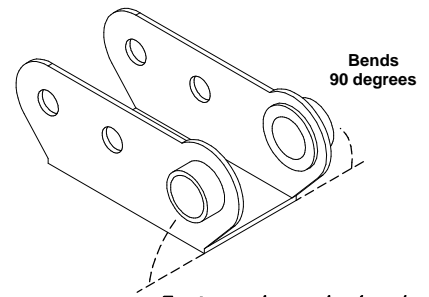

5. Strengthen the bends with solder and then clean up the etch.

6. Cut the D1 Idler Shaft to length (E) and slot it through the etch. Include an Idler Gear, Collar and Washer as you go.

RoadRunner Compact+

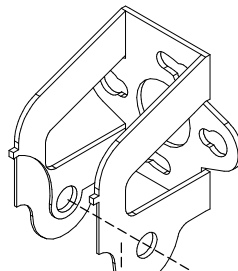

9. For a RoadRunner Compact+, the Gearbox Stage 1 Spacer (from the main gearbox) sits inside the etch with no external Spacer.

10. For LoadHauler Compact+ (see next page) the D2 Spacer is fitted outside the DriveStretcher.

11. If you wish to site the driven axle under the the motor, study the diagram overleaf...

7. Secure the ends of the shaft using a small amount of adhesive. Move the Collar up to the gear, until there is no sideplay, check the gear revolves freely and then glue the Collar in place. Be careful the glue doesn't stray into the gear.

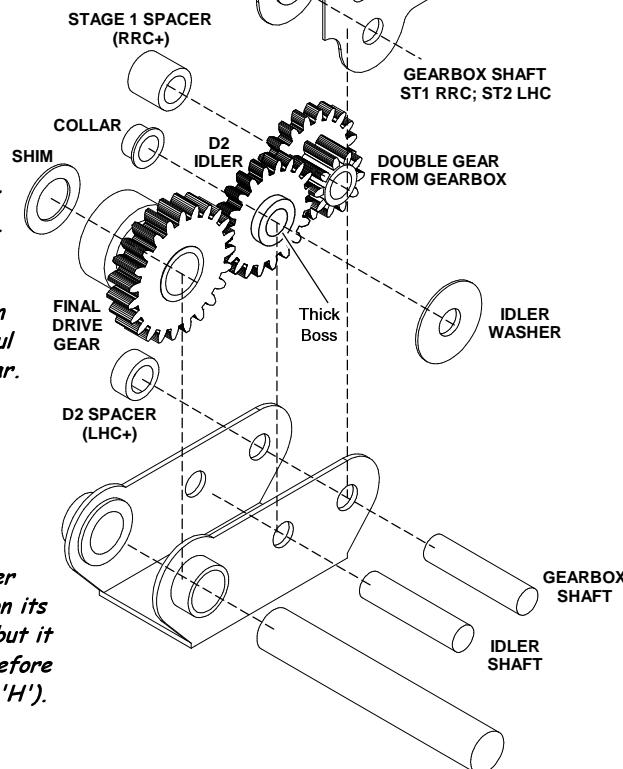

8. The DriveStretcher can be sited anywhere on its arc, facing either way, but it must be fixed in place before applying power (Section 'H').

12. Fit the Axle, 23T Gear and Spacer into the Carriage, and Shim as required (read 'J'). Tighten the Grubscrew and check all the gears revolve smoothly.

13. Revert back to the main Gearbox instructions to finish off.

D2 DriveStretcher

*For a reversed DriveStretcher
(running under the motor)
arrange the components
as shown.*

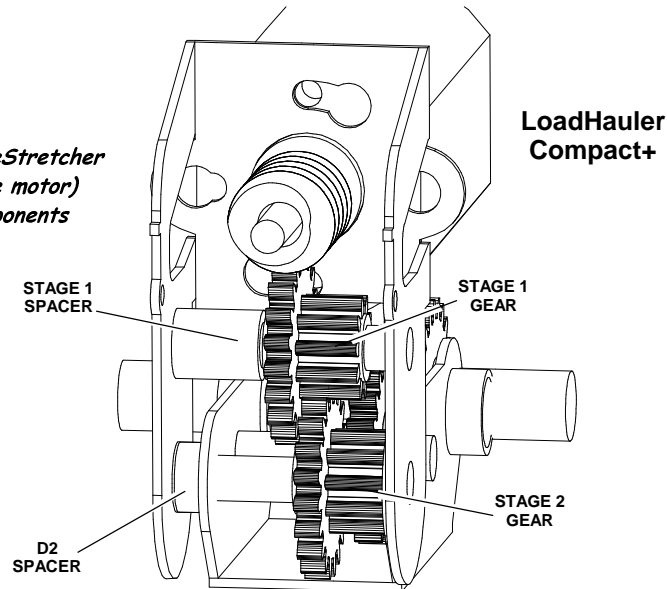

**D2 Facing
backwards**

*Be sure to secure the
Carriage in place once you have
determined the final position (H).*

*The D2 spacer is required for
the LoadHauler Compact+.
The DriveStretcher must
be hard up to the inner face of
the gearbox at the opposite side.*

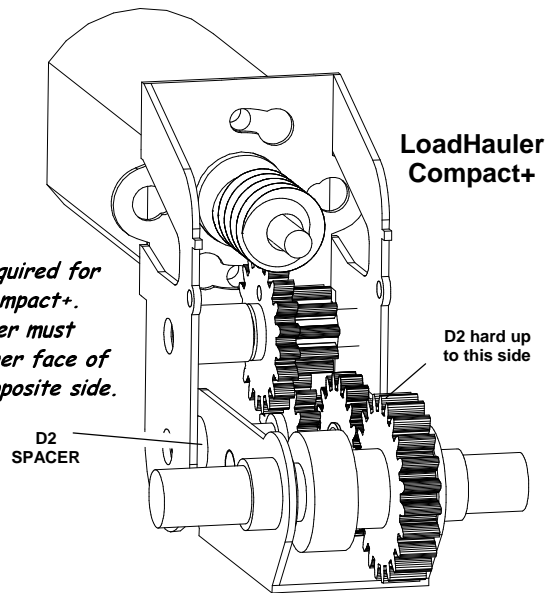

**D2 Facing
forwards**